



*For Lease*

**Educational Cooperative Center at Gatelot Elementary School**  
65 Gatelot Avenue, Ronkonkoma, NY

# 65 Gatelot Avenue, Ronkonkoma, NY

## Possible Divisions

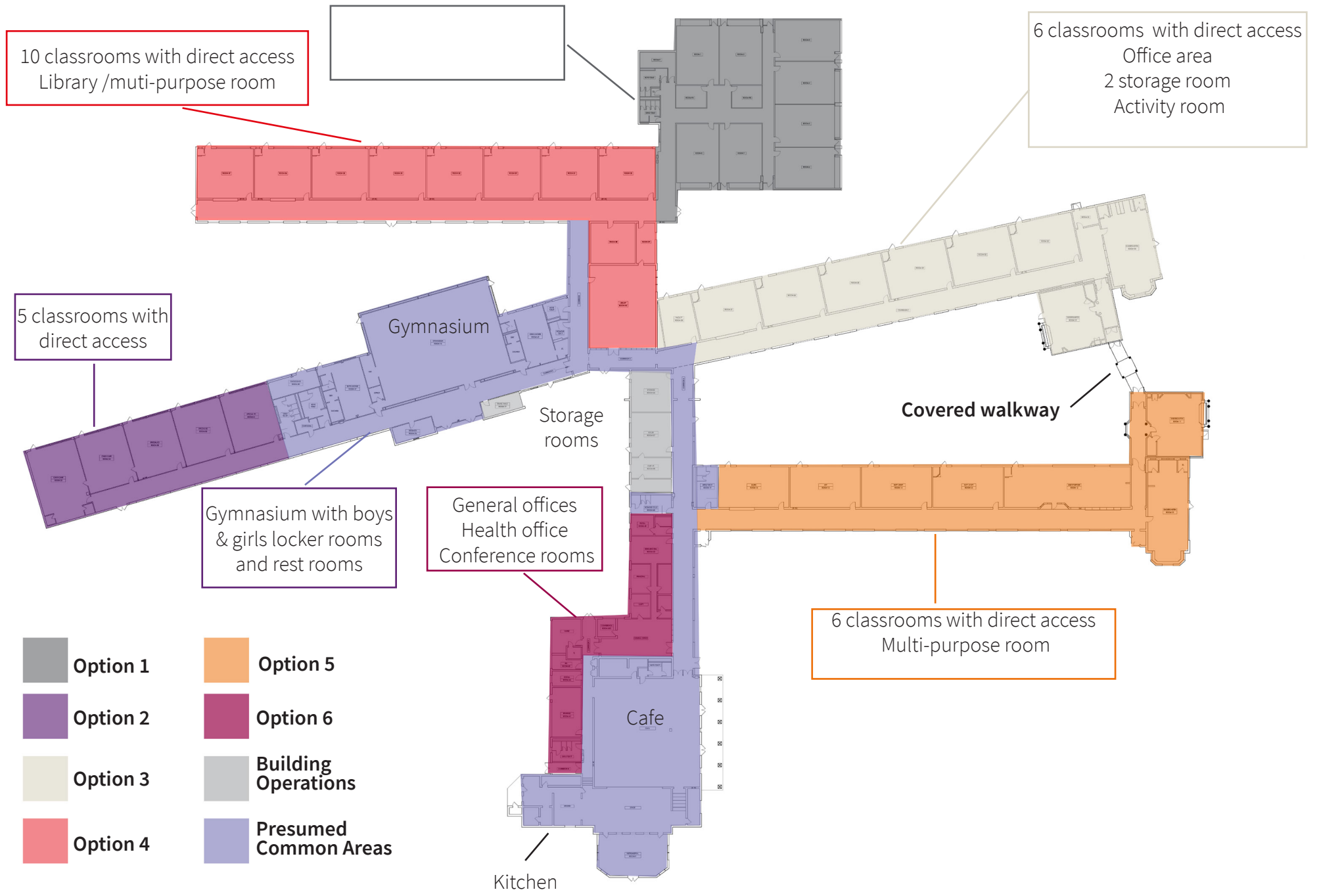

# Building Features

## Overview

Building size: 83,495 SF (divisible)

Plot size: 15.1 acres

Zoning: Community service

Pricing details: Please call for additional information

- Multiple updated playgrounds and sport fields surround the exterior of the building
- Abundant parking in front and rear of building
- Two main entrances, one with a drop off circle
- Main offices with fingerprint scanning system, PA system
- CCTV security system
- Voice over IP telephone system
- Additional Industrial freezer and refrigeration systems
- Portable serving line
- Loading dock
- Multi-purpose room: auditorium with adjoining rehearsal space/mobile cafeteria with adjacent commercial kitchen
- Wheel chair lift
- Classrooms with dedicated bathrooms
- Dual fired burners (natural gas & oil)
- Air conditioned server room
- Computer room
- Library
- Gymnasium with accordion partition plus boys & girls locker rooms with showers

[www.educationalassetsli.com](http://www.educationalassetsli.com)





# Contacts

**Ray Ruiz**  
+1 631 962 2890  
ray.ruiz@am.jll.com

**Marianne Dugan**  
+1 631 962 2891  
marianne.dugan@am.jll.com

**John A. Nielsen**  
+1 631 962 7382  
johna.nielsen@am.jll.com